

REVISION

0	JZ	L GELIN
2015/9/10	ECN-258532	
ISSUE FOR REVIEW		

NOT RELEASED FOR PRODUCTION

USE FOR QUOTING, PRELIMINARY DESIGN, PROTOTYPING AND INFORMATIONAL PURPOSES ONLY

BY SIGNING THIS DOCUMENT YOU ARE ACCEPTING THE CONDITIONS SET WITHIN. YOUR REQUIREMENTS MUST BE LISTED WITHIN THIS DRAWING. WHERE NO DIRECTION FROM THE CUSTOMER IS IDENTIFIED SAMTEC'S PROCESS REQUIREMENTS WILL BE USED.

DATE: \_\_\_\_\_  
 COMPANY: \_\_\_\_\_  
 CUSTOMER SIGNATURE: \_\_\_\_\_  
 PRINTED NAME: \_\_\_\_\_  
 PHONE NO: \_\_\_\_\_  
 EXCEPTIONS: \_\_\_\_\_

NOTES:

1. SETUP AS STANDARD PART.
2.  $\langle \text{XX.XX} \rangle$  REPRESENTS A CRITICAL DIMENSION.
3. CUSTOMER PART NUMBER 26125.
4. BURR ALLOWANCE: .038 [.0015].
5. MINIMUM PUSHOUT FORCE; TERMINALS: 2.22 N [.5 LBS], CONTACTS: 2.22 N [.5 LBS].
6. WHEN MATING WITH ANOTHER LSHM-DV, PIN 01 WILL MATE WITH CONTACT 02 ON MATING CONNECTOR. WHEN MATING WITH A LSHM-DH, PIN 01 WILL MATE WITH PIN N, WHERE N=TOTAL NUMBER OF POSITIONS.
7. MEASURE FROM TOP OF VERTICAL WALL.
8. PARTS TO BE PACKAGED IN TAPE & REEL.

DESIGNED & DIMENSIONED IN MILLIMETERS[INCHES]

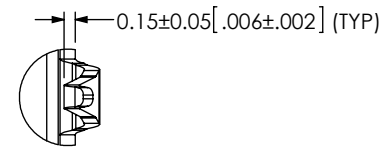
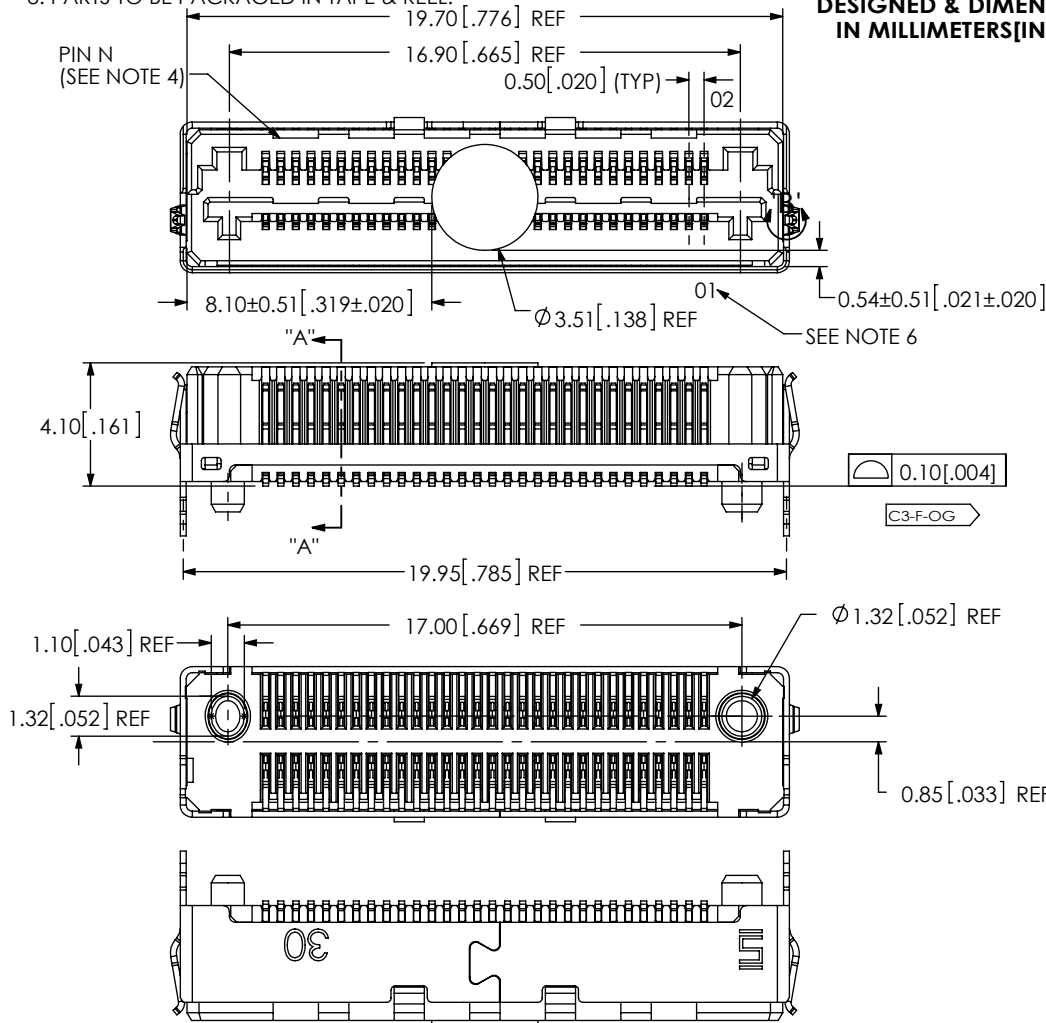

DETAIL 'B' SCALE 10:1

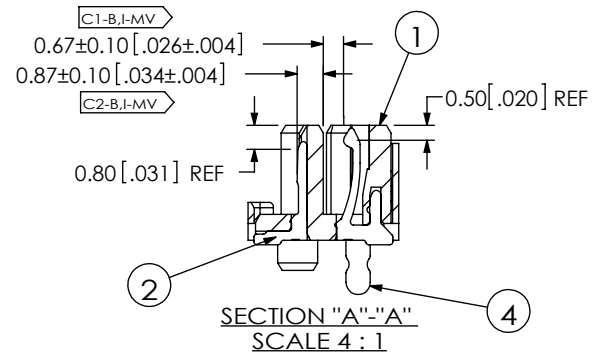
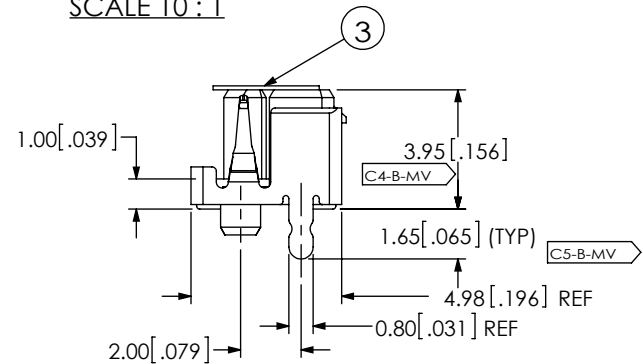

ITEM NO.	PART NUMBER	QUANTITY	MATERIAL
1	LSHM-30-02.5-DV-A	1.0000	VECTRA E130i, COLOR: BLACK
2	C-261-01-L	60.000	PHOS BRONZE
3	K-DOT-.138-.250-.005	1.0000	POLYIMIDE FILM
4	SH26-30-02.5-DV-N	1.0000	POLYAMIDE FILM (KAPTON)
5	CT-LSHM017MS	1.4372	CONDUCTIVE POLYMER

UNLESS OTHERWISE SPECIFIED, DIMENSIONS ARE IN MILLIMETERS[INCHES]. TOLERANCES ARE: DECIMALS ANGLES X.X:  $\pm 0.3$  [.01] 2° X.XX:  $\pm 0.13$  [.005] X.XXX:  $\pm 0.051$  [.0020]

PROPRIETARY NOTE THIS DOCUMENT CONTAINS CONFIDENTIAL AND PROPRIETARY INFORMATION AND ALL DESIGN, MANUFACTURING, REPRODUCTION, USE, PATENT RIGHTS AND SALES RIGHTS ARE EXPRESSLY RESERVED BY SAMTEC, INC. THIS DOCUMENT SHALL NOT BE DISCLOSED, IN WHOLE OR PART, TO ANY UNAUTHORIZED PERSON OR ENTITY NOR REPRODUCED, TRANSFERRED OR INCORPORATED IN ANY OTHER PROJECT IN ANY MANNER WITHOUT THE EXPRESS WRITTEN CONSENT OF SAMTEC, INC.

**samtec**  
 520 PARK EAST BLVD, NEW ALBANY, IN 47150  
 PHONE: 812-944-6733 FAX: 812-948-5047  
 e-Mail: info@SAMTEC.com code 55322

DESCRIPTION: 0.50mm TERMINAL/SOCKET COMBO  
 DWG. NO. REF-189017-01  
 BY: JOE Z 09/10/2015 SHEET 1 OF 2

DO NOT SCALE DRAWING SHEET SCALE: 4:1  
 PLATING: CONTACTS: CONTACT AREA: .000010 GOLD OVER .000050 NICKEL REMAINDER: .000200 REF TIN OVER .000050 NICKEL SHIELD: ENTIRE SHEL: .000050 NICKEL OVER .000020 MIN COPPER  
 F:\dwg\sw\ref\189000\REF-189017-01.SLDDRW

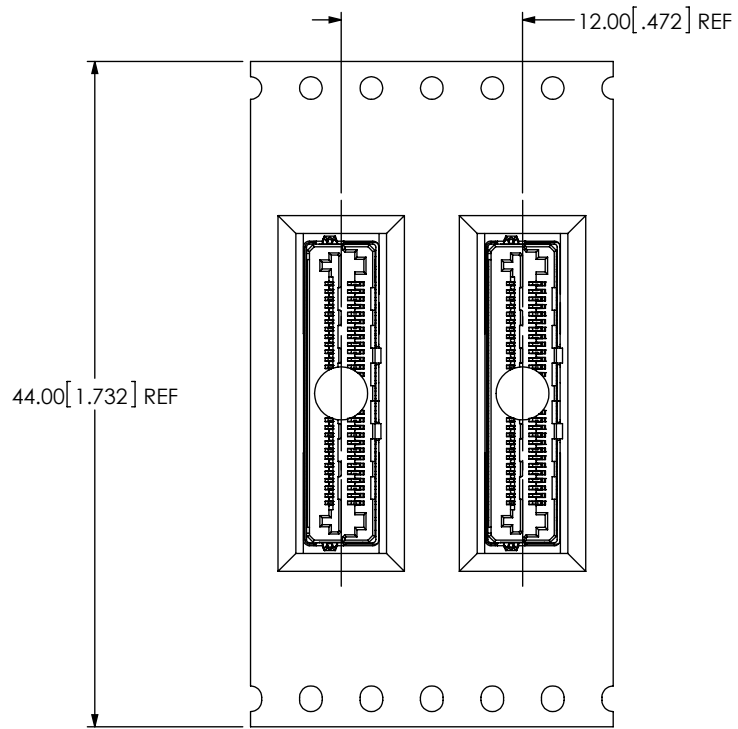

USER DIRECTION OF UN-REELING  
POCKET NOT DETAILED →

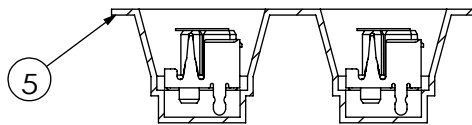

PACKAGING VIEW

PROPRIETARY NOTE

THIS DOCUMENT CONTAINS CONFIDENTIAL AND PROPRIETARY INFORMATION AND ALL DESIGN, MANUFACTURING, REPRODUCTION, USE, PATENT RIGHTS AND SALES RIGHTS ARE EXPRESSLY RESERVED BY SAMTEC, INC. THIS DOCUMENT SHALL NOT BE DISCLOSED, IN WHOLE OR PART, TO ANY UNAUTHORIZED PERSON OR ENTITY NOR REPRODUCED, TRANSFERRED OR INCORPORATED IN ANY OTHER PROJECT IN ANY MANNER WITHOUT THE EXPRESS WRITTEN CONSENT OF SAMTEC, INC.



520 PARK EAST BLVD, NEW ALBANY, IN 47150  
PHONE: 812-944-6733 FAX: 812-948-5047  
e-Mail info@SAMTEC.com code 55322

SHEET SCALE: 2:1

DESCRIPTION:  
0.50mm TERMINAL/SOCKET COMBO

DWG. NO.  
REF-189017-01

BY: JOE Z 09/10/2015 SHEET 2 OF 2